

Designated Class2 OTC medicine

Please be sure to read these instructions before usage,
and store them somewhere where they can be read if necessary.

TOUKI YOUKETSU SEI L

This product is made with the "touki" (Japanese Angelica root) extract, known to be effective for blood replenishment and invigoration together with other 9 crude drugs as active ingredients.



【Precautions】



Consultation

1. If the following conditions apply to you, please consult your doctor, pharmacist, or registered salesperson before taking this drug.
 - (1) Those who are receiving medical treatment.
 - (2) Those who have poor digestion and get diarrhea easily.
 - (3) Those who have experienced allergic reactions due to reasons such as taking medicine.
2. If the following symptoms are observed after taking this drug, these may be adverse reactions, so immediately discontinue the use of this drug, and show this document to your physician, pharmacist, or registered salesperson for a consultation.

Affected site	Symptom
Skin	Rash/reddening, itchiness
Digestive Organ	anorexia, nausea, vomiting

3. When symptoms do not improve even after taking the medicine for about 1 month, stop taking the preparation and consult a physician (dentist), pharmacist or registered salesperson, being sure to take this instruction leaflet with you.

【Indications】

The following menopause symptoms:

Coldness, anemia, irregular period, menstrual pain, stomachache, lower back pain, sore shoulders, headache, dizziness, hot flashes, ringing in the ears.

【Dosage and administration】

The following single dose should be taken twice a day before or after a meal.

Age	Single Dose	Doses per day
Adult (15 years old and over)	4mL	twice a day
Children (under 15 years old)	Please do not take it.	

<Precautions of Dosage and Administration>

Shake container well before use.

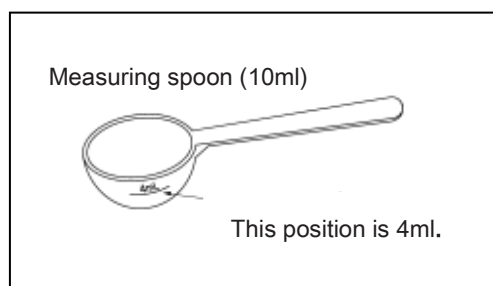

【Ingredients】

An adult (15 or older) daily dosage of 8.0mL contains the following ingredients and 4.8ml of extracted liquid from this amount.

Ingredients	Quantities
Japanese Angelica root	5.52 g
Astragalus Root	0.36 g
Rehmannia Root	0.36 g
Poria Sclerotium	0.36 g
Paony Root	0.36 g
Cnidium Rhizome	0.16 g
Glycyrrhiza	0.16 g
Radix Codonopsis	0.36 g
Donkey Glue	0.36 g

Includes white sugar and sodium benzoate as additives.

<Precautions relating to ingredient and amount>

This pill uses natural ingredients (herbal medicines), so in some cases color and taste may vary slightly by product, and there may be dried liquid on the upper part of the bottle.

Also, in rare cases there may be sediment, but this makes no difference to the effectiveness, so please shake it well before use.

【Precautions for storing and handling】

(1) Store in a cool dry place out of direct sunlight. After opening, to preserve quality, store in a cold dark place (approximately 3 - 10°C).

The product includes Donkey Glue, so in rare cases it may solidify, but if it does, please return to room temperature and shake well before using

(2) Keep it away from the reach of children.

(3) Do not change the container. (It can lead to misuse or loss of quality.)

(4) After each use, wipe the cap well, and always tighten it firmly after it is clean.

(5) After opening, use as soon as possible.

(6) Wash the attached measuring spoon after each use to keep it clean.

(7) Do not use any expired product.

【How to open the cap】

Open the cap first removing the transparent inner lid, then close the cap again and use it.

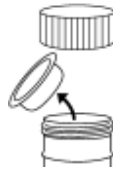

■Disclaimer on Multilingual OTC Product Information

- This product is a pharmaceutical product approved under a Japanese law, the Law for Ensuring the Quality, Efficacy and Safety of Drugs and Medical Devices, with a view to its sale and use in Japan.
- Multilingual product information is a translation of the product labeling written in Japanese and provided for your information only. It does not warrant that its contents and the product itself conforms to laws and regulations in countries other than Japan.
- Multilingual product information is a tentative translation by the provider (or Our Company), and may be modified or altered without notice.
- The provider (or Our Company) assumes no responsibility for any occurred problem attributable to the contents of the multilingual product information.

Multilingual product information is a tentative translation by the provider (or Our Company), and may be modified or altered without notice.

The provider (or Our Company) assumes no responsibility for any occurred problem attributable to the contents of the multilingual product information.

If you have some questions about the drug, please contact the pharmacy you purchased the product or the contact information below.

Yatsume Pharmaceutical Co., Ltd
(Customer Support Center)
Phone (03) 3680-0005
Reception hours 9:00~17:00
(excludes weekends and holidays)

Manufacturer : Yatsume Pharmaceutical Co., Ltd
2-14-14, Funabori, Edogawa-ku, Tokyo